

# THE HUDSON

*At Three Meadows*



## Key Features:

- 2523 SqFt. Living Area
- 4 Bedrooms 3 Full Baths
- Granite Countertops
- 9 ft. Ceilings
- Cascade LVP Flooring
- Ceramic Tile Baths
- Covered Patio
- Open Concept Kitchen/Great Room
- 30 Year Dimensional Shingles
- 2/10 QBW Home Warranty
- Gas Fireplace
- Frigidaire Stainless Steel Appliance Package

*2830 Three Meadows Dr., W. Lafayette*

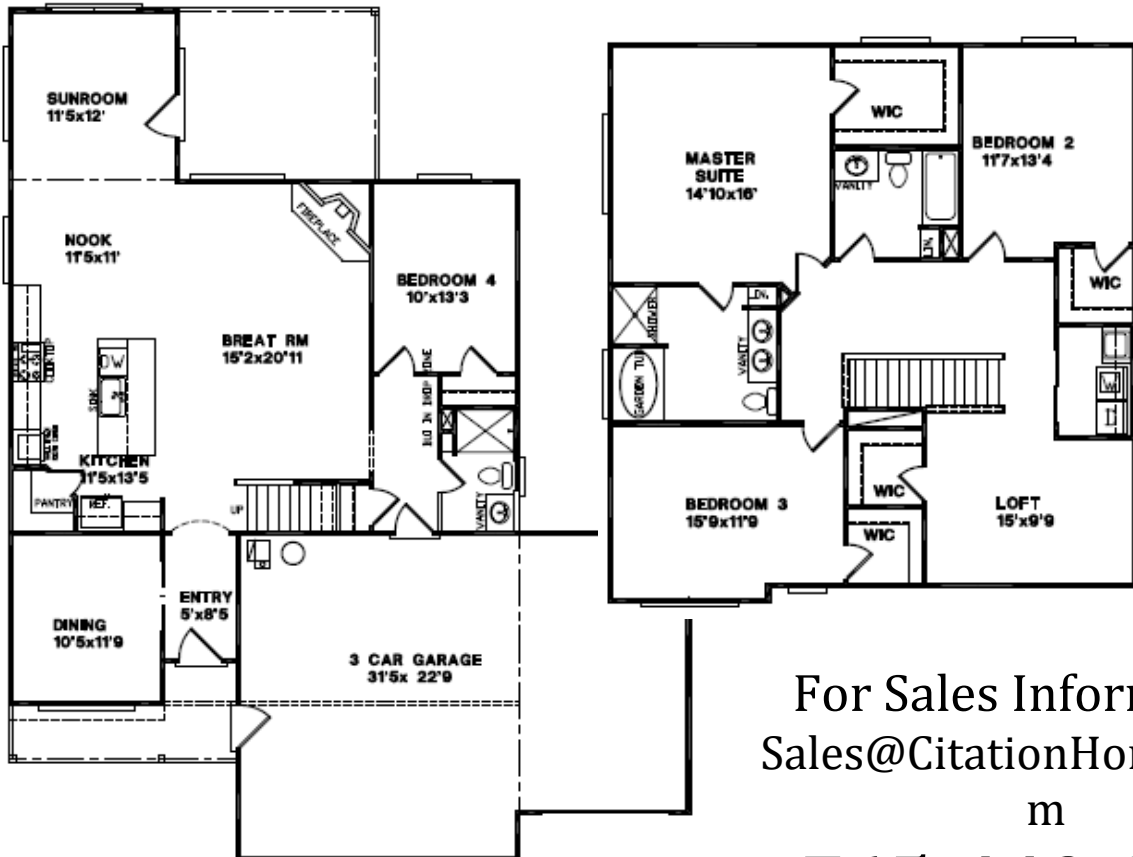

For Sales Information:  
[Sales@CitationHomesInc.com](mailto:Sales@CitationHomesInc.com)  
m

Visit us online at [www.CitationHomesInc.com](http://www.CitationHomesInc.com)

*The illustrations in this brochure are the artist's conceptions and are subject to change without notice.*